

Note: roof covering & underlayment as req'd by code.

Note: Spline to be of material conforming to DOC PS2, min thickness 7/16".

8d box (0.113) nails @ 3" o.c. both sides of panel joint or equivalent. (See SIP-139)

R-Control SIP.

R-Control Wood Screw, min. 1-5/8" penetration, see Load Design Charts for spacing requirements.

SIP Tape or equivalent vapor retarder located interior or exterior per climate conditions or code requirement.

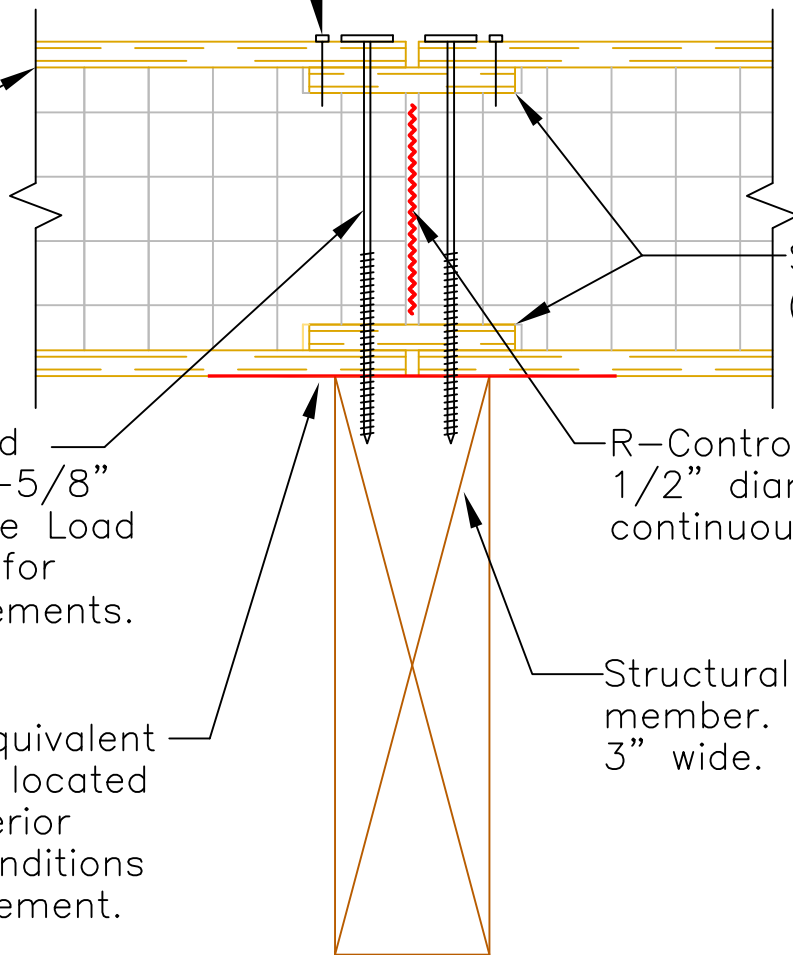

Surface spline (see SIP-102).

R-Control Do-All-Ply 1/2" diameter continuous bead.

Structural support member. Minimum 3" wide.

SECTION

Scale: NTS

Updated 1-16-12

R-Control® SIP

TITLE: Diaphragm Connection
- Intermediate support

NO.
SIP-141